



Description

- A #4 contact for a wide range of wire sizes: Size 8, 10, 16, 25 & 35 mm²
- Easy visual wire identification: Color band on contact
- Allow the use of small wire sections: Reducer for wires 8 & 10 mm² in contact barrel 16mm²
- Ideal for high power applications: Up to 200A continuous (12-01 specif. 261)
- Space & cost saving with mixed connectors: Only one connector instead of two to transmit signal & power

Technical specifications

Mechanical

Shell

Aluminium alloy

Shell plating

Conductive black zinc

Insulator

Thermoplastic

Grommet & seal

Liquid silicone rubber

Contact

Copper alloy

Contact plating

Gold over nickel

Endurance

500 mating cycles

Shock

300g for 3ms and EIA-364-27

Vibration

147m/s², 10 to 2000Hz

Contact retention

Size 22D:	45 N
Size 20:	60 N
Size 16:	100 N
Size 12:	100 N
Size 8:	110 N
Size 4:	200 N

Electrical

Test voltage

Service	M	N	I	II
Sea level	1,300	1,000	1,800	2,300

Contact resistance

Size 22D:	14.6 mΩ
Size 20:	7.3 mΩ
Size 16:	3.8 mΩ
Size 12:	3.5 mΩ
Size 8:	3 mΩ
Size 4:	2 mΩ

Insulation resistance

≥ 5000 MΩ (at 500 Vdc)

Contact rating

Size 22D:	5 A
Size 20:	7.5 A
Size 16:	13 A
Size 12:	23 A
Size 8:	45 A
Size 4:	80 A

Shell continuity

≤10 mΩ

Environmental

Operating temperature

-55°C to +175°C

Sealing mated connectors

IP67 (1 meter for 30 min minimum)

Salt spray

48 hours

8STA series power contacts

Contact layouts

Contact layouts viewed from front face of male insulator

Contact sizes ○ #22D ● #20 ◐ #16 ◑ #12 ◒ #8 Power ◓ #4 Power

10

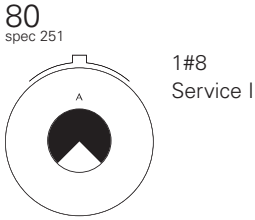

12

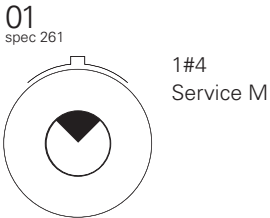

16

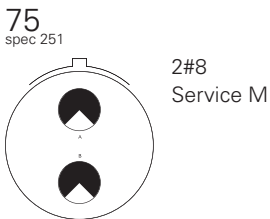
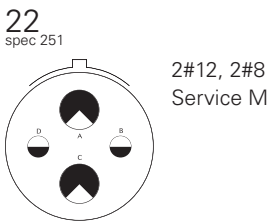
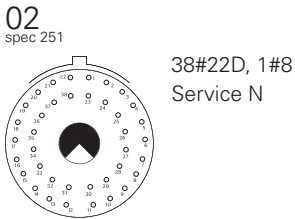

18

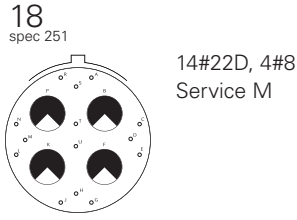

20

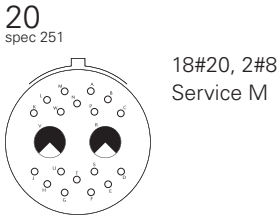

42

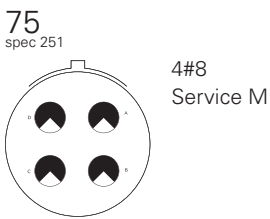
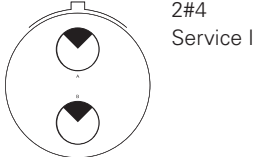

20

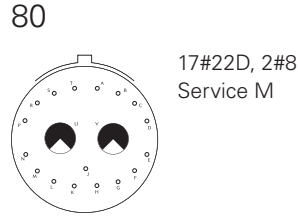

22

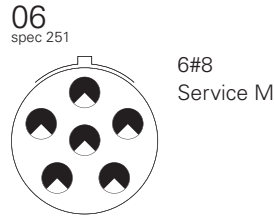

24

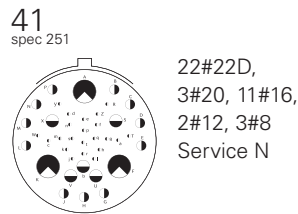
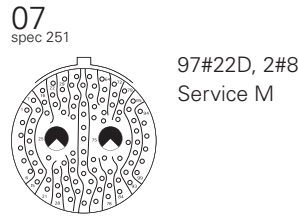

24

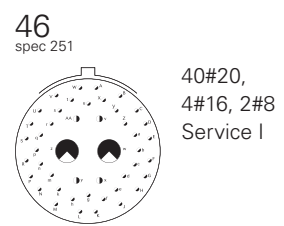
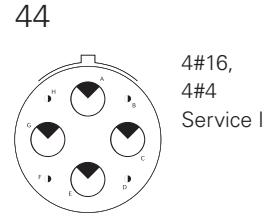

Part numbers

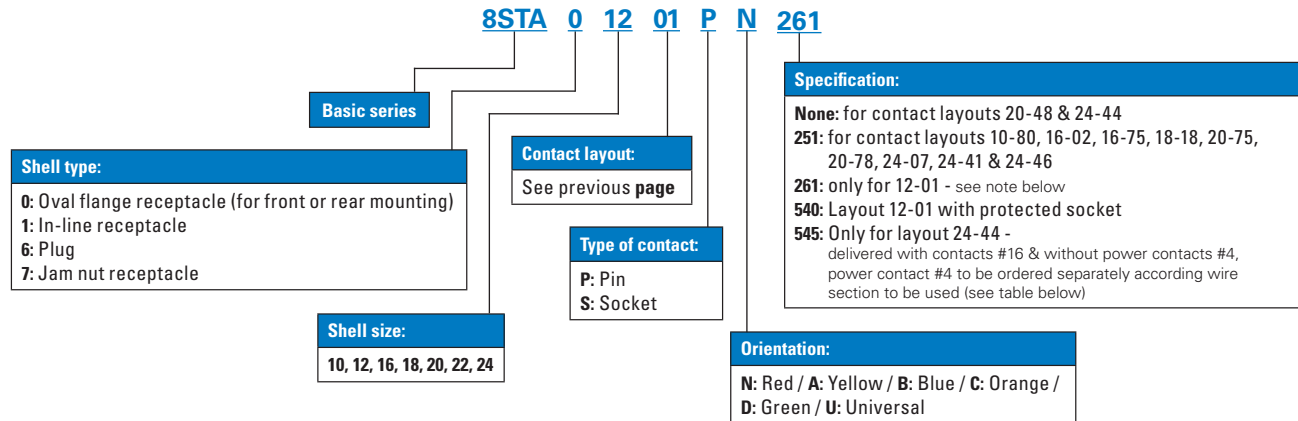

Note: Layout 12-01 specif. 261 only.

- 1) Standard connector (8STAx1201yz261 where x = shell type; y = type of cts; z = orientation) is provided with power contacts for 16mm² wire.
- 2) For 10mm² wire, order standard connector (note 1) + reducing sleeve 8400 2351 A separately.
- 3) For 25mm² wire, order connector without contact, see A & B details in type of contact (ex : 8STAx1201Az261 or Bz261) + contact separately (pin : 8599 7598 900 & socket : 8599 7599 900)
- 4) For 35mm² wire, order connector without contact, see A & B details in type of contact (ex : 8STAx1201Az261 or Bz261) + contact separately (pin : 8599 0313 & socket : 8599 0316)

Power contacts

Designation	Wire 16 mm ²	Wire 25 mm ²	Wire 35 mm ²
	Removable contact	Removable contact	Non removable contact
Color band	Red	Blue	Green
Pin contact	8599 7520A 900	8599 7598 900	8599 0313
Socket contact	8599 7521A 900	8599 7599 900	8599 0316
Reducer - wire 8 & 10 mm²	8400 2351A	-	-
Crimping tool	M22520/23-01 + Die M22520/23-04 + Positionner M22520/23-11 And for widerer 50 mm ² : M22520/23-01+ Die WA23-4 + Positionner WA23-176L	M22520/23-01 + Die M22520/23-04 + Positionner M22520/23-11	M22520/23-01 + Die 8599-0319 + Positionner 8599-0318 (male) + Positionner 8599-0317 (female)
Plastic extraction tool	M81969/14-07 (blue)	M81969/14-07 (blue)	-

Specific wire dimensions

Power contact #4

Pin contact

Socket contact

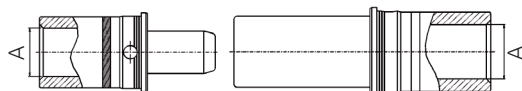

Cable section	A		
	16 mm ²	25 mm ²	35 mm ²
Contact Ø	6.5 Min.	7.33 Min.	8.65 Min.
Color band	Red	Blue	Green

Reducer for wire 8 and 10 mm²

Compatible with pin and socket contact, wire 16 mm²

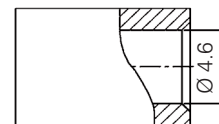

Note: All dimensions are in millimeters (mm)