

# Series SMA – cable connectors

## Straight cable plugs (male)

### For semi-rigid cables

- With pin and insulator
- Cable entry soldered
- Centre contact soldered

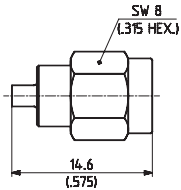
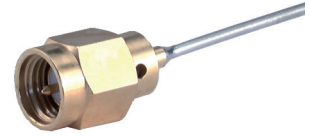

Fig. 1

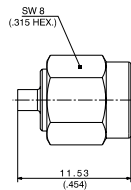

Fig. 2

HUBER+SUHNER type	Item no.	Cable group (example)	Packaging	Assembly instruction	Plating body	Fig.	Notes
11_SMA-50-1-1/111_NE <sup>1)2)</sup>	22642387	Y19 (EZ_34)	single	9118	gold	1	
11_SMA-50-1-2/111_NE <sup>1)2)</sup>	22642388	Y2, Y15 (SUCOFORM_47, EZ_47)	single	9119		1	
11_SMA-50-1-53/119_NH	23013327	Y2, Y15 (SUCOFORM_47, EZ_47)	bulk 100 pcs.	150006		2	nut passivated stainless steel

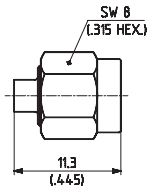

Fig. 1

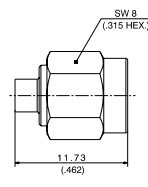
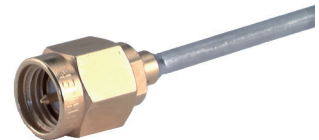

Fig. 2



HUBER+SUHNER type	Item no.	Cable group (example)	Packaging	Assembly instruction	Plating body	Fig.	Notes
11_SMA-50-2-15/111_NE <sup>5)</sup>	22544545	Y3, Y11, Y16 (SUCOFORM_86, EZ_86)	single	9056	gold	1	
11_SMA-50-2-15/111_NH	22645898		bulk 100 pcs.				
11_SMA-50-2-65/119_NE <sup>3)5)</sup>	22642315	Y3, Y11, Y16 (SUCOFORM_86, EZ_86)	single	9056	gold	1	nut passivated stainless steel
11_SMA-50-2-65/119_NH <sup>3)</sup>	22645366		bulk 100 pcs.				
11_SMA-50-2-110/133_NE <sup>4)</sup>	84130715	Y3, Y11, Y16 (SUCOFORM_86, EZ_86)	single	0000349249	SUCO-PLATE®	2	
11_SMA-50-2-110/133_NP <sup>4)</sup>	84117816		bulk 500 pcs.				

All highlighted types are HUBER+SUHNER ECO types.

<sup>1)</sup> Compound 74\_Z-0-0-116 needed

<sup>2)</sup> SUCOPRO® (economical) version on request

<sup>3)</sup> Cable entry CuBe/gold

<sup>4)</sup> Use torque wrench 74\_Z-0-0-79

<sup>5)</sup> SUCOPRO® (economical) version on request

# Series SMA – cable connectors

## Straight cable plugs (male)

### For semi-rigid cables

- With pin and insulator
- Cable entry soldered
- Centre contact soldered

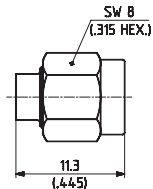

Fig. 1

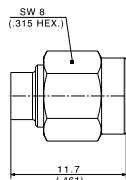

Fig. 2

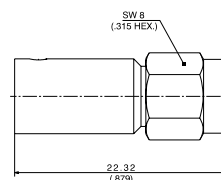
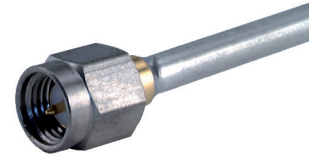

Fig. 3



HUBER+SUHNER type	Item no.	Cable group (example)	Packaging	Assembly instruction	Plating body	Fig.	Notes
11_SMA-50-3-15/111_NE <sup>2)</sup> 11_SMA-50-3-15/111_NH	22544547 22651601	Y5, Y12, Y17 (SUCOFORM_141, EZ_141)	single bulk 100 pcs.	9056	gold	1	
11_SMA-50-3-65/119_NE 11_SMA-50-3-65/119_NH	22641643 22646570	Y5, Y12, Y17 (SUCOFORM_141, EZ_141)	single bulk 100 pcs.	9056	gold	1	nut passivated stainless steel
11_SMA-50-3-235/133_NE <sup>1)</sup> 11_SMA-50-3-235/133_NP <sup>1)</sup>	84130698 84104274	Y5, Y12, Y17 (SUCOFORM_141, EZ_141)	single bulk 500 pcs.	0000333508	SUCO-PLATE®	2	
11_SMA-50-5-1/111_NE <sup>2)</sup>	22642399	Y7, Y14 (SUCOFORM_250_01, EZ_250)	single	0000181414	gold	3	

All highlighted types are HUBER+SUHNER ECO types.

## 26.5 GHz – straight cable plugs (male)

### For semi-rigid cables

- With pin and insulator
- Centre contact soldered

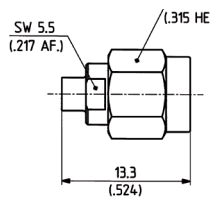

Fig. 1

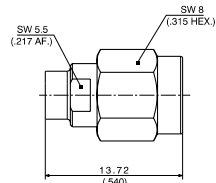
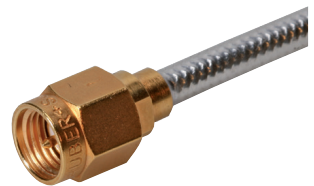

Fig. 2



HUBER+SUHNER type	Item no.	Cable group (example)	Packaging	Assembly instruction	Fig.	Plating body
11_SMA-50-2-100/111_NE <sup>2)</sup>	22648717	Y3, Y11, (SUCOFORM_86, EZ_86)	single	0000181590	1	gold
11_SMA-50-3-100/111_NE <sup>2)</sup> 11_SMA-50-3-100/111_NH	22648718 22658936	Y5, Y12, Y17 (SUCOFORM_141, EZ_141)	single bulk 100 pcs.		2	

<sup>1)</sup> Use torque wrench 74\_Z-0-0-79

<sup>2)</sup> SUCOPRO® (economical) version on request

# Series SMA – cable connectors

## 26.5 GHz – straight cable plugs (male)

For semi-rigid cables

- Without pin and insulator

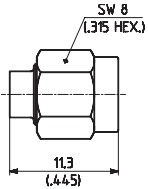
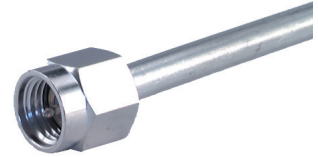

Fig. 1

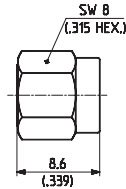

Fig. 2

HUBER+SUHNER type	Item no.	Cable group (example)	Packaging	Assembly instruction	Plating body	Fig.	Notes
11_SMA-50-3-14/-11_NH	22644467	Y5 (EZ_141)	bulk 100 pcs.	9055	gold	1	
11_SMA-50-3-16/-11_NH	22644470		bulk 100 pcs.		gold	2	
11_SMA-50-3-42/-33_NE	22649222		single		SUCOPLATE®	2	
11_SMA-50-3-42/-33_NH	22646128		bulk 100 pcs.				
11_SMA-50-3-64/-19_NH	22649224		bulk 100 pcs.		gold	1	nut passivated stainless steel
11_SMA-50-3-66/-19_NE	22641644	single bulk 100 pcs.	gold	2	nut passivated stainless steel		
11_SMA-50-3-66/-19_NH	22645207						

## Straight cable plugs (male)

For flexible cables

- Cable entry clamp
- Centre contact soldered

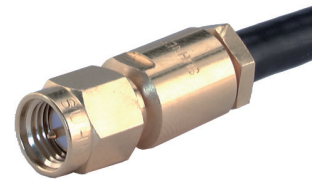
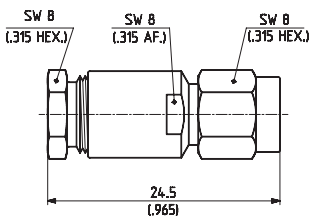

HUBER+SUHNER type	Item no.	Cable group (example)	Packaging	Assembly instruction	Plating body
11_SMA-50-3-7/111_NE <sup>1)</sup>	22640050	U7 (RG_58_C/U, ENVIROFLEX_B58)	single	3071	gold
11_SMA-50-3-8/111_NH <sup>1)</sup>	22648630	U9 (RG_142_B/U, ENVIROFLEX_142)	bulk 100 pcs.		
11_SMA-50-3-10/111_NE <sup>1)</sup>	22640053	U11 (RG_400_/U, ENVIROFLEX_400)	single		

<sup>1)</sup> SUCOPRO® (economical) version on request

# Series SMA – cable connectors

## Straight cable plugs (male)

### For flexible cables

- Cable entry crimp
- Centre contact soldered

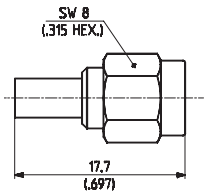

Fig. 1

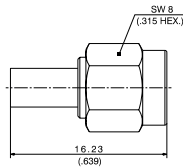

Fig. 2



HUBER+SUHNER type	Item no.	Cable group (example)	Packaging	Assembly instruction	Plating body	Crimp insert	Fig.
11_SMA-50-1-4/111_NE <sup>3)</sup>	22645871	U1 (RG_178_B/U, ENVIROFLEX_178)	single	27061	gold	A	1
11_SMA-50-2-5/111_NE <sup>3)</sup> 11_SMA-50-2-5/111_NH	22640042 22646312	U2 (RG_316_/U, ENVIROFLEX_316)	single bulk 100 pcs.	27266	gold	A	1
11_SMA-50-2-6/111_NE <sup>3)</sup> 11_SMA-50-2-6/111_NH	22640043 22650740	U4 (K_02252_D, ENVIROFLEX_316_D)	single bulk 100 pcs.	27266	gold	A	1
11_SMA-50-2-27/111_NE <sup>1), 3)</sup> 11_SMA-50-2-27/111_NH <sup>1)</sup>	84022967 22652923	U2 (RG_316_/U, ENVIROFLEX_316)	single bulk 100 pcs.	27164	gold	1 A	1
11_SMA-50-2-55/199_NE	22641377	U2 (RG_316_/U, ENVIROFLEX_316)	single	3069	passivated stainless steel	A	1
11_SMA-50-2-56/199_NE 11_SMA-50-2-56/199_NH	22641376 22651486	U4 (K_02252_D, ENVIROFLEX_316_D)	single bulk 100 pcs.	3069	passivated stainless steel	A	1
11_SMA-50-2-111/133_NE <sup>2)</sup> 11_SMA-50-2-111/133_NP <sup>2)</sup>	84130699 84117820	U2 (RG_316_/U, ENVIROFLEX_316_D)	single bulk 500 pcs.	0000348839	SUCOPLATE®	A	2
11_SMA-50-2-112/133_NE <sup>2)</sup> 11_SMA-50-2-112/133_NP <sup>2)</sup>	84130700 84115820	U4 (K_02252_D, ENVIROFLEX_316_D)	single bulk 500 pcs.	0000347891	SUCOPLATE®	A	2

All highlighted types are HUBER+SUHNER ECO types.

<sup>1)</sup> HUBER+SUHNER full crimp

<sup>2)</sup> use torque wrench 74\_Z.0-0-79

<sup>3)</sup> SUCOPRO® (economical) version on request

# Series SMA – cable connectors

## Straight cable plugs (male)

### For flexible cables

- Cable entry crimp
- Centre contact soldered (11\_SMA-50-4-77 plugged center conductor)



SMA

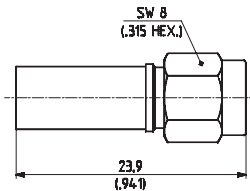

Fig. 1

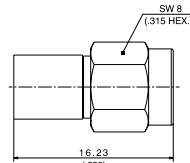

Fig. 2

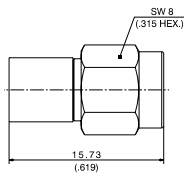

Fig. 3

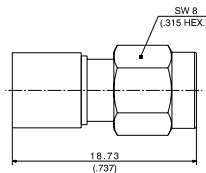

Fig. 4

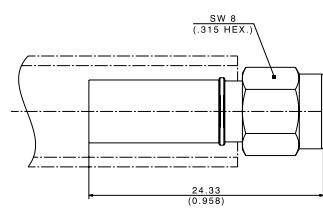

Fig. 5

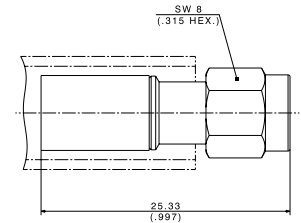

Fig. 6

HUBER+SUHNER type	Item no.	Cable group (example)	Packaging	Assembly instruction	Plating body	Crimp insert	Fig.
11_SMA-50-3-5/111_NE <sup>2)</sup> 11_SMA-50-3-5/111_NH	22640048 22644684	U7 (RG_58_C/U, ENVIROFLEX_B58)	single bulk 100 pcs.	3069	gold	B	1
11_SMA-50-3-6/111_NE <sup>2)</sup> 11_SMA-50-3-6/111_NH	22640049 22650739	U9, U11 (RG_400_/U, ENVIROFLEX_400)	single bulk 100 pcs.	3069	gold	B	1
11_SMA-50-3-55/199_NE	22641371	U7 (RG_58_C/U, ENVIROFLEX_B58)	single	3069	passivated stainless steel	B	1
11_SMA-50-3-56/199_NE 11_SMA-50-3-56/199_NH	22543647 22648300	U9, U11 (RG_400_/U, ENVIROFLEX_400)	single bulk 100 pcs.	3069	passivated stainless steel	B	1
11_SMA-50-3-236/133_NE <sup>1)</sup> 11_SMA-50-3-236/133_NP <sup>1)</sup>	84130702 84117821	U9, U11, U41 (RG_400_/U, ENVIROFLEX_400)	single bulk 500 pcs.	0000349507	SUCOPLATE®	1 <sup>3)</sup>	2
11_SMA-50-3-237/133_NE <sup>1)</sup> 11_SMA-50-3-237/133_NP <sup>1)</sup>	84130703 84117823	U7 (RG_58_C/U, ENVIROFLEX_B58)	single bulk 500 pcs.	0000349571	SUCOPLATE®	B	3
11_SMA-50-3-239/133_NF	85010668	X27 (SPUMA_195, SPUMA_195-FR-01)	single	0000417562	SUCOPLATE®	B	5
11_SMA-50-4-50/133_NE <sup>1)</sup> 11_SMA-50-4-50/133_NP <sup>1)</sup>	84130705 84112519	S16, X9 (SX_04172_B-60)	single bulk 500 pcs.	0000347768	SUCOPLATE®	2 <sup>4)</sup>	4
11_SMA-50-4-77/133_NE	85010193	X28 (SPUMA_240, SPUMA_240-FR-01)	single	0000416855	SUCOPLATE®	C	6

All highlighted types are HUBER+SUHNER ECO types.

<sup>1)</sup> Use torque wrench 74\_Z0-0-79

<sup>2)</sup> SUCOPRO® (economical) version on request

<sup>3)</sup> Crimp tool 76\_Z0-0-57

<sup>4)</sup> Crimp tool 76\_Z0-4-23

# Series SMA – cable connectors

## Right angle cable plugs (male)

### For semi-rigid cables

- With pin and insulator
- Cable entry soldered
- Centre contact soldered

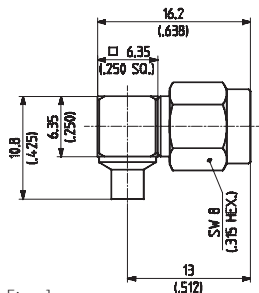

Fig. 1

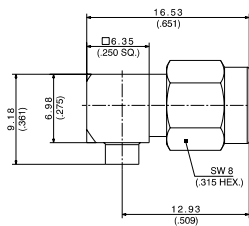

Fig. 2



HUBER+SUHNER type	Item no.	Cable group (example)	Packaging	Assembly instruction	Plating body	Fig.	Notes
16_SMA-50-2-53/119_NE 16_SMA-50-2-53/119_NH	22644242 22646639	Y3, Y11, Y16 (SUCOFORM_86, EZ_86)	single bulk 100 pcs.	3068	gold	1	nut passivated stainless steel
16_SMA-50-2-103/111_NE <sup>2)</sup> 16_SMA-50-2-103/111_NH	84018309 22652924	Y3, Y11, Y16 (SUCOFORM_86, EZ_86)	single bulk 100 pcs.	3068	gold	1	
16_SMA-50-2-110/133_NE <sup>1)</sup> 16_SMA-50-2-110/133_NP <sup>1)</sup>	84130706 84117807	Y3, Y11, Y16 (SUCOFORM_86, EZ_86)	single bulk 500 pcs.	0000335631	SUCO-PLATE®	2	

All highlighted types are HUBER+SUHNER ECO types.

- With pin and insulator
- Cable entry soldered
- Centre contact soldered

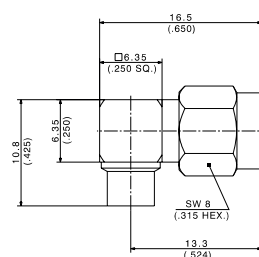

Fig. 1

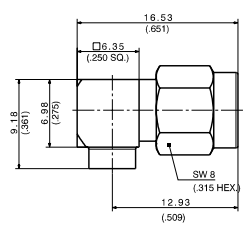

Fig. 2



HUBER+SUHNER type	Item no.	Cable group (example)	Packaging	Assembly instruction	Plating body	Fig.	Notes
16_SMA-50-3-3/111_NE <sup>2)</sup> 16_SMA-50-3-3/111_NH	22640073 22646569	Y5, Y12, Y17 (SUCOFORM_141, EZ_141)	single bulk 100 pcs.	3068	gold	1	
16_SMA-50-3-13/133_NE <sup>1)</sup> 16_SMA-50-3-13/133_NP <sup>1)</sup>	84130707 84117810	Y5, Y12, Y17 (SUCOFORM_141, EZ_141)	single bulk 500 pcs.	0000335642	SUCO-PLATE®	2	
16_SMA-50-3-53/119_NE 16_SMA-50-3-53/119_NH	22644243 22646561	Y5, Y12, Y17 (SUCOFORM_141, EZ_141)	single bulk 100 pcs.	3068	gold	1	nut passivated stainless steel

All highlighted types are HUBER+SUHNER ECO types.

<sup>1)</sup> Use torque wrench 74\_Z-0-0-79

<sup>2)</sup> SUCOPRO® (economical) version on request

# Series SMA – cable connectors

## 26.5 GHz – right angle cable plugs (male)

### For semi-rigid cables

- With pin and insulator
- Cable entry soldered
- Centre contact plugged

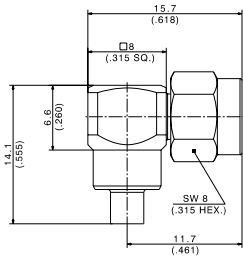

Fig. 1

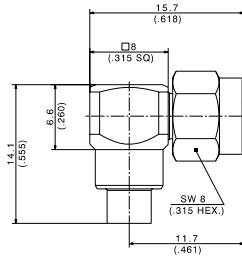
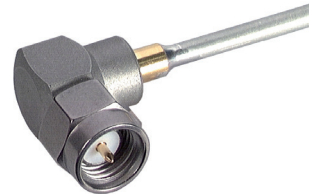

Fig. 2



SMA

HUBER+SUHNER type	Item no.	Cable group (example)	Packaging	Assembly instruction	Plating body	Fig.
16_SMA-50-2-100/199_NH	23018813	Y3, Y11, Y16 (SUCOFORM_86, EZ_86)	bulk 100 pcs.	27055	passivated stainless steel	1
16_SMA-50-3-100/199_NE	22648293	Y5, Y12, Y17 (SUCOFORM_141, EZ_141)	single			2

# Series SMA - cable connectors

## Right angle cable plugs (male)

### For flexible cables

- Cable entry crimp
- Centre contact soldered

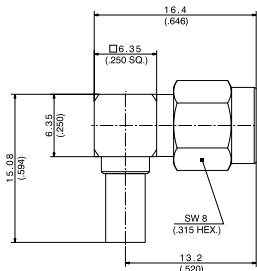

Fig. 1

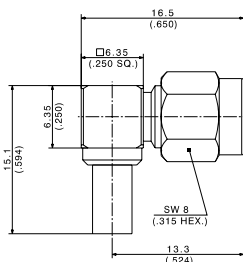

Fig. 2

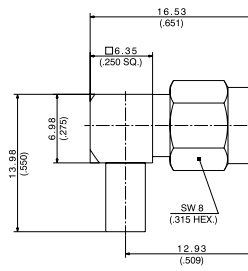

Fig. 3



HUBER+SUHNER type	Item no.	Cable group (example)	Packaging	Assembly instruction	Plating body	Crimp insert	Fig.
16_SMA-50-1-1/111_NE <sup>2)</sup> 16_SMA-50-1-1/111_NH	22641805 22660358	U1 (RG_178_B/U, ENVIROFLEX_178)	single bulk 100 pcs.	3070	gold	A	1
16_SMA-50-2-55/199_NE 16_SMA-50-2-55/199_NH	22642661 84028953	U2 (RG_316_/U, ENVIROFLEX_316)	single bulk 100 pcs.	3070	passivated stainless steel		2
16_SMA-50-2-56/199_NE 16_SMA-50-2-56/199_NH	22642662 22658888	U4 (K_02252_D, ENVIROFLEX_316_D)	single bulk 100 pcs.	3070	passivated stainless steel		2
16_SMA-50-2-105/111_NE <sup>2)</sup> 16_SMA-50-2-105/111_NH	22651455 22651456	U2 (RG_316_/U, ENVIROFLEX_316)	single bulk 100 pcs.	3070	gold		1
16_SMA-50-2-106/111_NE <sup>2)</sup> 16_SMA-50-2-106/111_NH	22651457 22651458	U4 (K_02252_D, ENVIROFLEX_316_D)	single bulk 100 pcs.	3070	gold		1
16_SMA-50-2-111/133_NE <sup>1)</sup> 16_SMA-50-2-111/133_NP <sup>1)</sup>	84130708 84117808	U2 (RG_316_/U, ENVIROFLEX_316)	single bulk 500 pcs.	0000335656	SUCOPLATE®		3
16_SMA-50-2-112/133_NE <sup>1)</sup> 16_SMA-50-2-112/133_NP <sup>1)</sup>	84130709 84117809	U4 (K_02252_D, ENVIROFLEX_316_D)	single bulk 500 pcs.	0000335656	SUCOPLATE®		3

All highlighted types are HUBER+SUHNER ECO types.

<sup>1)</sup> Use torque wrench 74\_Z-0-0-79

<sup>2)</sup> SUCOPRO® (economical) version on request



# Series SMA – cable connectors

## Right angle cable plugs (male)

### For flexible cables

- Cable entry crimp
- Centre contact soldered



SMA

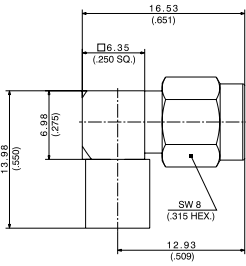

Fig. 1

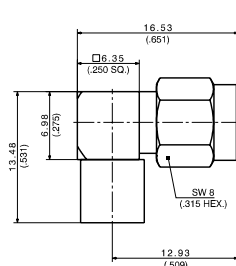

Fig. 2

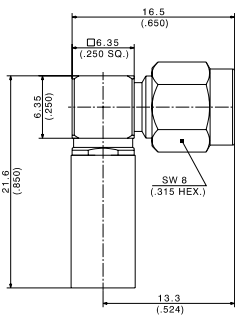

Fig. 3

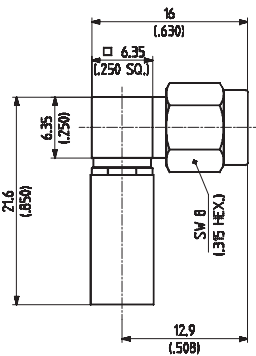

Fig. 4

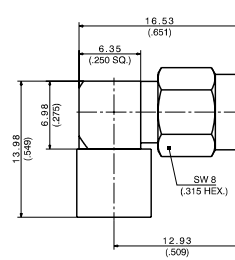

Fig. 5

HUBER+SUHNER type	Item no.	Cable group (example)	Packaging	Assembly instruction	Plating body	Crimp insert	Fig.
16_SMA-50-3-14/133_NE <sup>1)</sup> 16_SMA-50-3-14/133_NP <sup>1)</sup>	84130711 84117811	U9, U11, U41 (RG_400_/U, ENVIROFLEX_400)	single bulk 500 pcs.	0000335678	SUCOPLATE®	B	1
16_SMA-50-3-15/133_NE <sup>1)</sup> 16_SMA-50-3-15/133_NP <sup>1)</sup>	84130712 84117812	U7 (RG_58_C/U, ENVIROFLEX_B58)	single bulk 500 pcs.	0000335679	SUCOPLATE®	B	2
16_SMA-50-3-56/199_NE	22642660	U9, U11 (RG_400_/U, ENVIROFLEX_400)	single	3070	passivated stainless steel	B	3
16_SMA-50-3-105/111_NE <sup>2)</sup> 16_SMA-50-3-105/111_NH	22651585 22651800	U7 (RG_58_C/U, ENVIROFLEX_B58)	single bulk 100 pcs.	3070	gold	B	4
16_SMA-50-3-106/111_NE <sup>2)</sup> 16_SMA-50-3-106/111_NH	22650546 22650545	U9, U11 (RG_400_/U, ENVIROFLEX_400)	single bulk 100 pcs.	3070	gold	B	4
16_SMA-50-4-50/133_NE <sup>1)</sup> 16_SMA-50-4-50/133_NP <sup>1)</sup>	84130714 84117813	S16, X9 (SX_04172_B-60)	single bulk 500 pcs.	0000335684	SUCOPLATE®	C	5

All highlighted types are HUBER+SUHNER ECO types.

<sup>1)</sup> Use torque wrench 74\_Z-0-0-79

<sup>2)</sup> SUCOPRO® (economical) version on request

# Series SMA – cable connectors

## Straight cable jacks (female)

### For semi-rigid cables

- Cable entry soldered
- Centre contact soldered

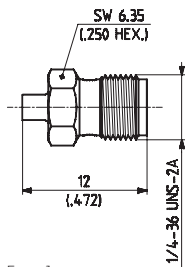

Fig. 1

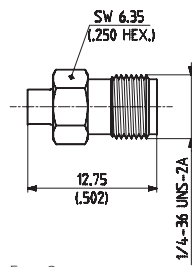

Fig. 2

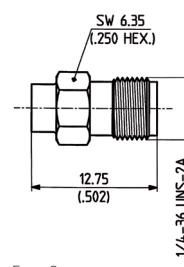

Fig. 3



HUBER+SUHNER type	Item no.	Cable group (example)	Packaging	Assembly instruction	Plating body	Fig.
21_SMA-50-1-1/111_NE <sup>1)</sup>	22642385	Y19 (EZ_34)	single	9118	gold	1
21_SMA-50-1-2/111_NE	22642386	Y2, Y15 (SUCOFORM_47, EZ_47)	single	9119		1
21_SMA-50-2-15/111_NE <sup>1)</sup>	22544549	Y3, Y11, Y16 (SUCOFORM_86, EZ_86)	single	9057		2
21_SMA-50-2-15/111_NH	22652141		bulk 100 pcs.			
21_SMA-50-3-15/111_NE <sup>1)</sup>	22544550	Y5, Y12, Y17 (SUCOFORM_141, EZ_141)	single	9057		3
21_SMA-50-3-15/111_NH	22645042		bulk 100 pcs.			

<sup>1)</sup> SUCOPRO® (economical) version on request

# Series SMA – cable connectors

## Straight cable jacks (female)

### For flexible cables

- Cable entry crimp
- Centre contact soldered

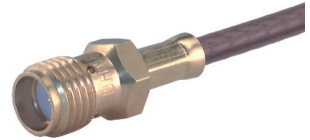
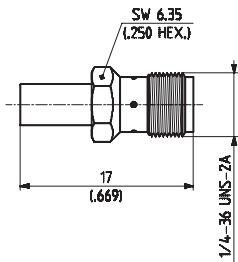

SMA

HUBER+SUHNER type	Item no.	Cable group (example)	Packaging	Assembly instruction	Plating body	Crimp insert
21_SMA-50-2-5/111_NE <sup>1)</sup>	22640077	U2 (RG_316_/U, ENVIROFLEX_316)	single	3069	gold	A
21_SMA-50-2-6/111_NE <sup>1)</sup> 21_SMA-50-2-6/111_NH	22640078 22651818	U4 (K_02252_D, ENVIROFLEX_316_D)	single bulk 100 pcs.			

- Cable entry crimp
- Centre contact soldered

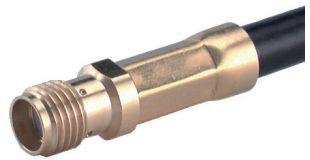
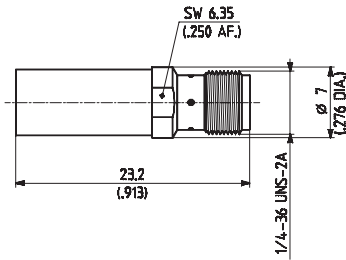

HUBER+SUHNER type	Item no.	Cable group (example)	Packaging	Assembly instruction	Plating body	Crimp insert
21_SMA-50-3-5/111_NE <sup>1)</sup>	22640081	U7 (RG_58_C/U, ENVIROFLEX_B58)	single	3069	gold	B
21_SMA-50-3-6/111_NE <sup>1)</sup>	22640082	U9, U11, U39 (RG_400_/U, ENVIROFLEX_400)				

<sup>1)</sup> SUCOPRO® (economical) version on request

# Series SMA - cable connectors

## Straight bulkhead cable jacks (female)

### For semi-rigid cables

- Cable entry soldered
- Centre contact soldered
- With panel seal

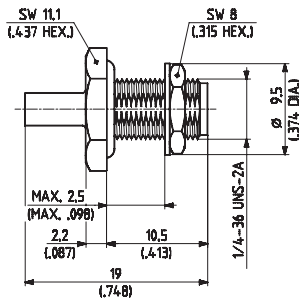
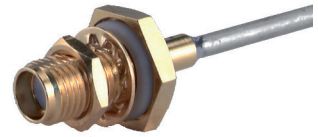

Fig. 1

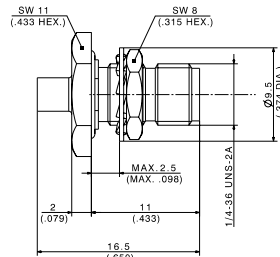

Fig. 2

HUBER+SUHNER type	Item no.	Cable group (example)	Packaging	Assembly instruction	Plating body	Mounting hole	Fig.
24_SMA-50-2-15/111_NE <sup>1)</sup> 24_SMA-50-2-15/111_NH	22544532 22645490	Y3, Y11, Y16 (SUCOFORM_86)	single bulk 100 pcs.	9057	gold	ML 35	1
24_SMA-50-2-41/133_NE 24_SMA-50-2-41/133_NH	22641381 22645368	Y3, Y11, Y16 (SUCOFORM_86)	single bulk 100 pcs.	0000185051	SUCOPLATE®	ML 20	2

All highlighted types are HUBER+SUHNER ECO types.

- Cable entry soldered
- Centre contact soldered
- With panel seal

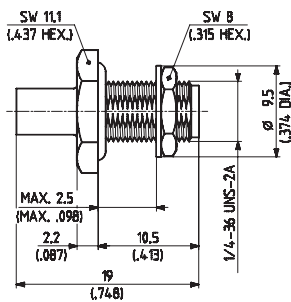
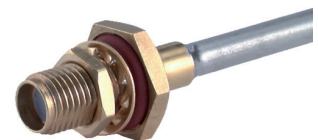

Fig. 1

HUBER+SUHNER type	Item no.	Cable group (example)	Packaging	Assembly instruction	Plating body	Mounting hole	Fig.
24_SMA-50-3-15/111_NE <sup>1)</sup> 24_SMA-50-3-15/111_NH	22641153 22645259	Y5, Y12, Y17 (SUCOFORM_141, EZ_141)	single bulk 100 pcs.	9057	gold	ML 35	1

<sup>1)</sup> SUCOPRO® (economical) version on request

# Series SMA – cable connectors

## 26.5 GHz – straight bulkhead cable jacks (female)

### For semi-rigid cables

- Cable entry soldered
- Centre contact soldered

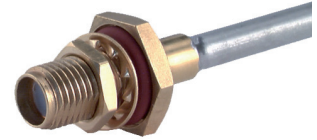

SMA

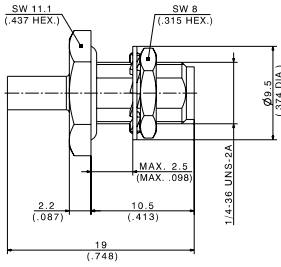

Fig. 1

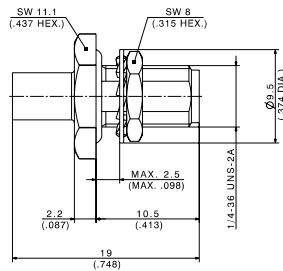

Fig. 2

HUBER+SUHNER type	Item no.	Cable group (example)	Packaging	Assembly instruction	Plating body	Mounting hole	Fig.
24_SMA-50-2-100/111_NE <sup>1)</sup>	22648727	Y3, Y11, Y16 (SUCOFORM_86, EZ_86)	single	27055	gold	M1.35	1
24_SMA-50-3-100/111_NE <sup>1)</sup>	22648728	Y5, Y12, Y17 (SUCOFORM_141, EZ_141)	single				2

<sup>1)</sup> SUCOPRO® (economical) version on request

# Series SMA - cable connectors

## Straight bulkhead cable jacks (female)

### For flexible cables

- Cable entry crimp
- Centre contact soldered

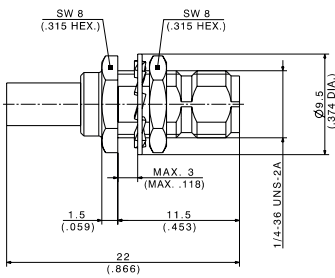

Fig. 1

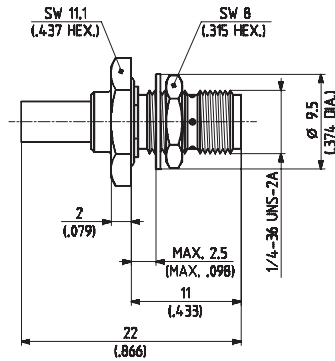

Fig. 2

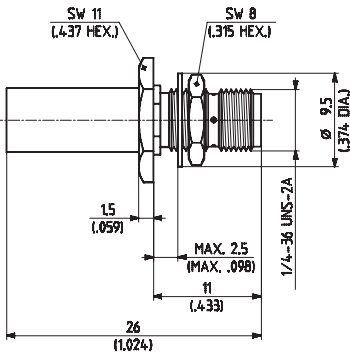

Fig. 4

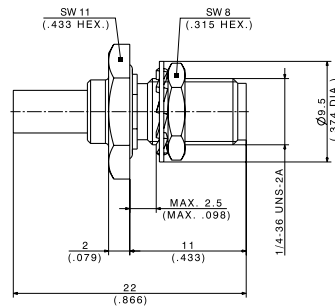

Fig. 5

HUBER+SUHNER type	Item no.	Cable group (example)	Packaging	Assembly instruction	Plating body	Crimp insert	Mounting hole	Fig.
24_SMA-50-1-3/111_NE <sup>1)</sup>	22649873	U1 (RG_178, ENVIROFLEX_178)	single	27104	gold	A	ML 35	1
24_SMA-50-2-13/111_NE <sup>1)</sup> 24_SMA-50-2-13/111_NH	22651767 22651719	U4 (K_02252_D, ENVIROFLEX_316_D)	single bulk 100 pcs.	3069	gold	A	ML 20	2
24_SMA-50-2-14/111_NE <sup>1)</sup> 24_SMA-50-2-14/111_NH	22651748 22651747	U2 (RG_316_/U, ENVIROFLEX_316)	single bulk 100 pcs.	3069	gold	A	ML 20	2
24_SMA-50-2-37/133_NE	85013993	U4 (K_02252_D, ENVIROFLEX_316_D)	single	3069	SUCOPLATE®	A	ML 20	4
24_SMA-50-2-46/133_NE 24_SMA-50-2-46/133_NH	22644246 22646565	U2 (RG_316_/U, ENVIROFLEX_316)	single bulk 100 pcs.	3069	SUCOPLATE®	A	ML 20	2
24_SMA-50-3-42/133_NE	22641358	U9 (RG_142_B/U, ENVIROFLEX_142)	single	3072	SUCOPLATE®	B	ML 20	3

All highlighted types are HUBER+SUHNER ECO types.

<sup>1)</sup> SUCOPRO® (economical) version on request

# Series SMA – cable connectors

## Straight panel cable jacks (female)

### For semi-rigid cables

- Cable entry soldered
- Centre contact soldered

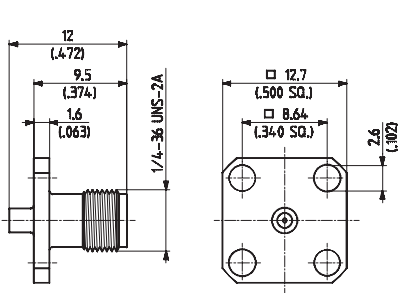

Fig. 1

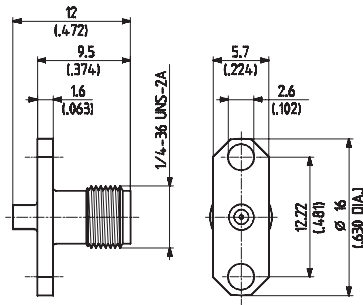
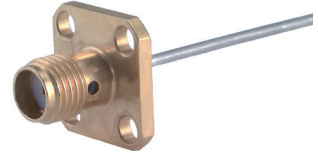

Fig. 2



SMA

HUBER+SUHNER type	Item no.	Cable group (example)	Packaging	Assembly instruction	Plating body	Mounting hole	Fig.
25_SMA-50-1-2/111_NE <sup>2)</sup>	22642390	Y2, Y15 (SUCOFORM_47, EZ_47)	single	9119	gold	ML 19	1
25_SMA-50-1-4/111_NE <sup>2)</sup>	22642391	Y2, Y15 (SUCOFORM_47, EZ_47)	single bulk 100 pcs.	9119		-	2
25_SMA-50-2-15/111_NE <sup>1)2)</sup>	22544551	Y3, Y11, Y16 (SUCOFORM_86, EZ_86)	single	9057		ML 19	1
25_SMA-50-2-25/111_NE <sup>1)2)</sup>	22641493	Y3, Y11, Y16 (SUCOFORM_86, EZ_86)	single	9057		-	2

<sup>1)</sup> Centre contact not captivated

<sup>2)</sup> SUCOPRO® (economical) version on request

# Series SMA - cable connectors

## Straight panel cable jacks (female)

### For semi-rigid cables

- Cable entry soldered
- Centre contact soldered

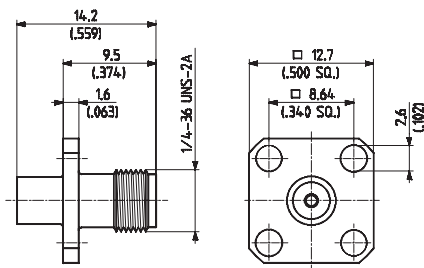

Fig. 1

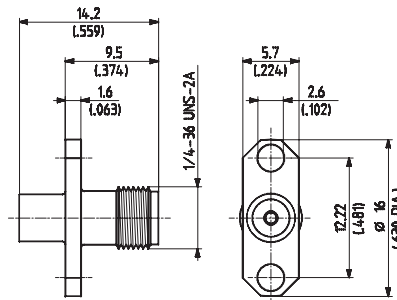
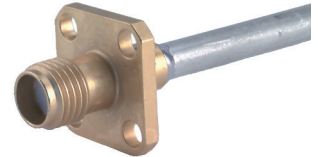
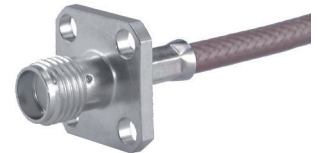
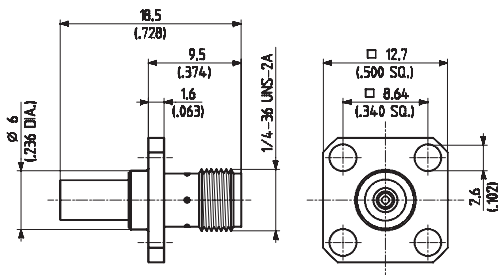

Fig. 2



HUBER+SUHNER type	Item no.	Cable group (example)	Packaging	Assembly instruction	Plating body	Mounting hole	Fig.
25_SMA-50-3-15/111_NE <sup>1)2)</sup> 25_SMA-50-3-15/111_NH <sup>1)</sup>	22544552 22644717	Y5, Y12, Y17 (SUCOFORM_141, EZ_141)	single bulk 100 pcs.	9057	gold	ML 19	1
25_SMA-50-3-25/111_NE <sup>1)2)</sup>	22641410	Y5, Y12, Y17 (SUCOFORM_141, EZ_141)	single			-	2

- Cable entry crimp
- Centre contact soldered



HUBER+SUHNER type	Item no.	Cable group (example)	Packaging	Assembly instruction	Plating body	Mounting hole	Crimp insert
25_SMA-50-2-5/111_NE <sup>2)</sup> 25_SMA-50-2-5/111_NH	22640112 22650755	U2 (RG_316_/U, ENVIROFLEX_316)	single bulk 100 pcs.	3072	gold	ML 19	A
25_SMA-50-2-6/111_NE <sup>2)</sup>	22640113	U4 (K_02252, ENVIROFLEX_316_D)	single				
25_SMA-50-2-46/133_NE	22642246	U4 (K_02252, ENVIROFLEX_316_D)	single	3072	SUCOPLATE®	ML 19	A

All highlighted types are HUBER+SUHNER ECO types.

<sup>1)</sup> Centre contact not captivated  
<sup>2)</sup> SUCOPRO® (economical) version on request



# Series SMA - receptacles

## Straight bulkhead receptacles

With solder end, jacks (female)

- With panel seal

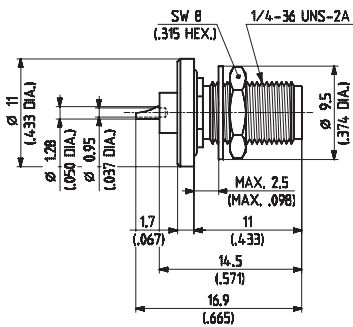

HUBER+SUHNER type	Item no.	Packaging	Plating body	Mounting hole	Mounting
22_SMA-50-0-1/111_NE	22640087	single	gold	ML 20	rear mounting

- Without panel seal

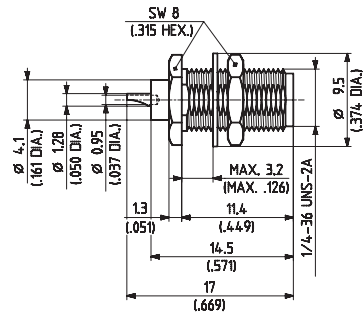

HUBER+SUHNER type	Item no.	Packaging	Plating body	Mounting hole	Mounting
22_SMA-50-0-4/111_NE	22640962	single	gold	ML 35	rear mounting
22_SMA-50-0-4/111_NH	22649418	bulk 100 pcs.	gold	ML 35	rear mounting

# Series SMA - receptacles

## Straight bulkhead receptacles

With coaxial end, jacks (female)

- Without panel seal

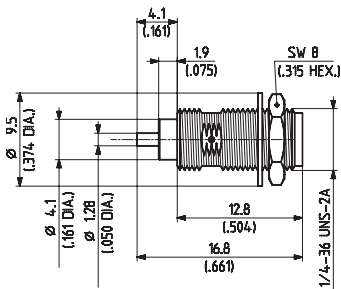
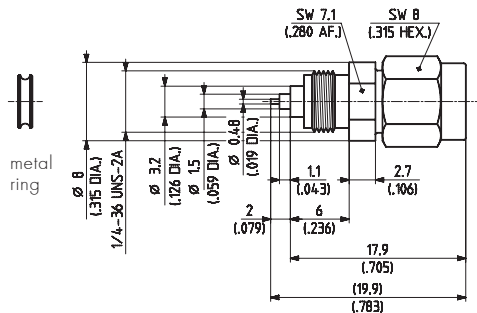

Fig. 1

HUBER+SUHNER type	Item no.	Packaging	Plating body	Mounting hole	Mounting	Fig.
22_SMA-50-0-3/111_NE	22640089	single	gold	ML 98	front mounting	1
22_SMA-50-0-53/199_NE	22543498	single	passivated stainless steel			

## Hermetically sealed, plug (male)

- "Spark plug" with metal ring seal
- RoHs compliant alternative on request
- Front mounting



HUBER+SUHNER type	Item no.	Packaging	Plating body	Mounting hole	Notes
12_SMA-50-0-110/111_NE <sup>1)</sup>	22652315	single	gold	ML 42	leak rate $\leq 10^{-8}$ Torr l/s (atm cc/s)

<sup>1)</sup> Use assembly tool 74\_Z0-0-75 and torque wrench 74\_Z0-0-80.

# Series SMA – receptacles

## Straight bulkhead receptacles

### Hermetically sealed, jacks (female)

- RoHs compliant alternative on request
- Front mounting

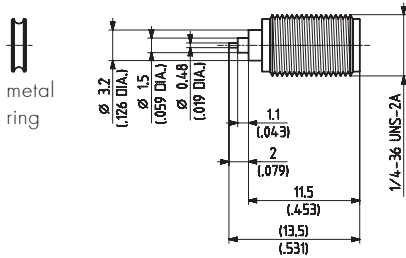

Fig. 1

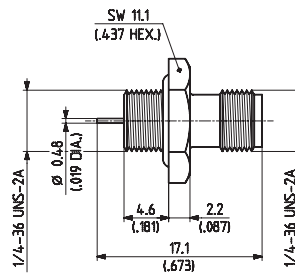

Fig. 2

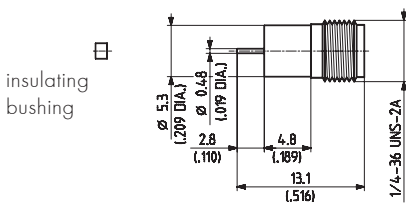

Fig. 3

HUBER+SUHNER type	Item no.	Packaging	Plating body	Mounting hole	Fig.	Notes
22_SMA-50-0-10/111_NE <sup>1)</sup>	22641291	single	gold	ML 42	1	"Spark plug" with metal ring seal leak rate $\leq 10^{-8}$ Torr l/s (atm cc/s)
22_SMA-50-0-12/111_NE 22_SMA-50-0-12/111_NY	84042904 22641293	single tray 75 pcs.		ML 98	2	with panel seal leak rate $\leq 10^{-6}$ Torr l/s (atm cc/s)
22_SMA-50-0-15/111_NE	22544588	single		ML 96	3	panel sealing: laser beam welding <sup>1)</sup> soldering temperature 250 °C/482 °F leak rate $\leq 10^{-8}$ Torr l/s (atm cc/s)

<sup>1)</sup> Use assembly tool 74\_Z-0-0-75 and torque wrench 74\_Z-0-0-80.

# Series SMA - receptacles

## Straight panel receptacles

With solder end, jacks (female)

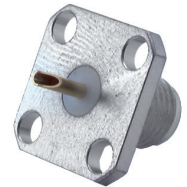
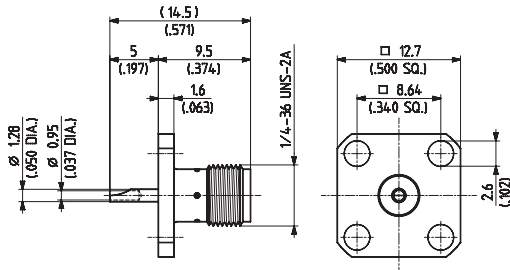

HUBER+SUHNER type	Item no.	Packaging	Plating body	Notes
23_SMA-50-0-1/111_NE	22640090	single	gold	flush dielectric
23_SMA-50-0-1/111_NH	22651409	bulk 100 pcs.		
23_SMA-50-0-51/199_NE	22543948	single	passivated stainless steel	

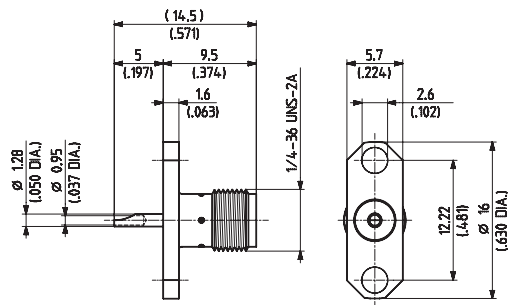

HUBER+SUHNER type	Item no.	Packaging	Plating body	Notes
23_SMA-50-0-11/111_NE	22640095	single	gold	flush dielectric
23_SMA-50-0-41/133_NE	22543984	single	SUCOPLATE®	flush dielectric
23_SMA-50-0-41/133_NH	22644383	bulk 100 pcs.		
23_SMA-50-0-61/199_NE	22544796	single	passivated stainless steel	flush dielectric

All highlighted types are HUBER+SUHNER ECO types.

With tab end, plug (male)

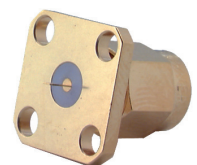
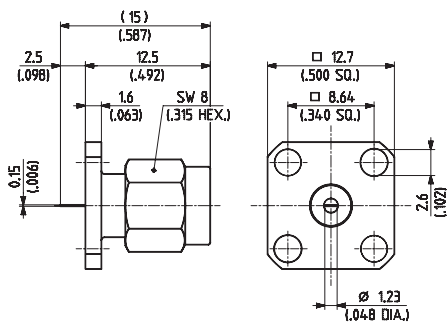

HUBER+SUHNER type	Item no.	Packaging	Plating body	Notes
13_SMA-50-0-2/111_NE	22640056	single	gold	flush dielectric

# Series SMA - receptacles

## Straight panel receptacles

With tab end, jacks (female)

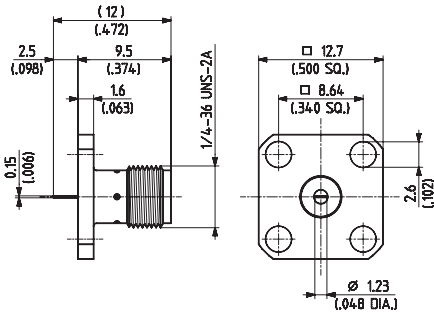

HUBER+SUHNER type	Item no.	Packaging	Plating body	Notes
23_SMA-50-0-2/111_NE	22640091	single	gold	flush dielectric
23_SMA-50-0-52/199_NE	22543487		passivated stainless steel	

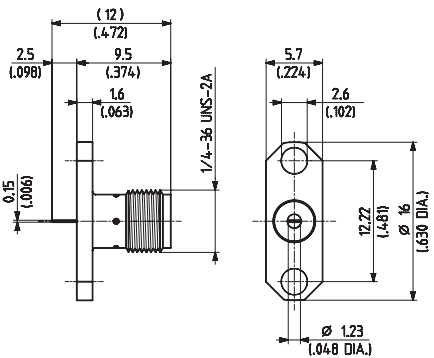

HUBER+SUHNER type	Item no.	Packaging	Plating body	Notes
23_SMA-50-0-12/111_NE	22640096	single	gold	flush dielectric
23_SMA-50-0-62/199_NE	22544779		passivated stainless steel	

# Series SMA - receptacles

Straight panel receptacles

With coaxial end, jacks (female)

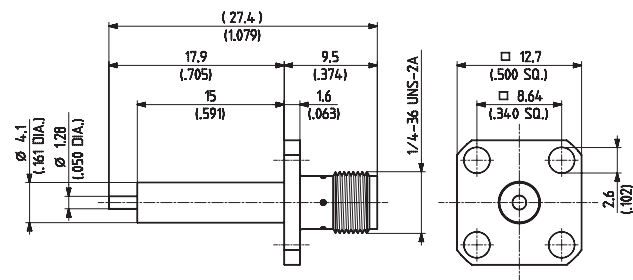
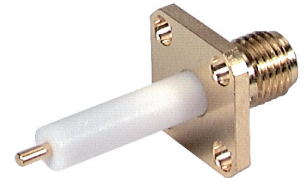

Fig. 1

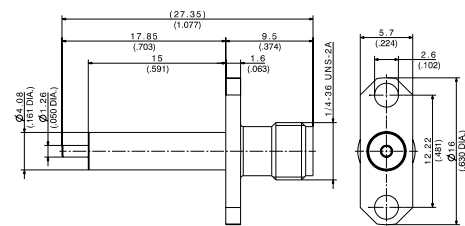

Fig. 2

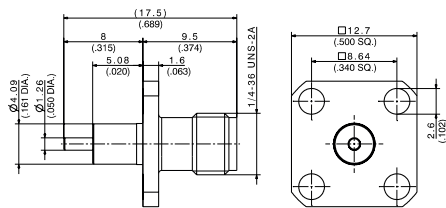

Fig. 3

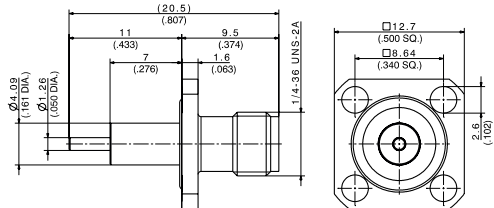

Fig. 4

HUBER+SUHNER type	Item no.	Packaging	Plating body	Notes	Fig.
23_SMA-50-0-3/111_NE	22640092	single	gold	extended dielectric	1
23_SMA-50-0-13/111_NE	22640097	single	gold	extended dielectric	2
23_SMA-50-0-13/111_NH	22658873	bulk 100 pcs.			
23_SMA-50-0-53/199_NE	22641394	single	passivated stainless steel	extended dielectric	1
23_SMA-50-0-53/199_NH	22649843				
23_SMA-50-0-272/133_NH	23030310	bulk 100 pcs	SUCOPLATE®	extended dielectric	3
23_SMA-50-0-324/111_NY	84035778	tray 100 pcs.	SUCOPRO® gold plating	extended dielectric with panel sealing	4

All highlighted types are HUBER+SUHNER ECO types.

# Series SMA - receptacles

## Straight panel receptacle

With coaxial end, jack (female)

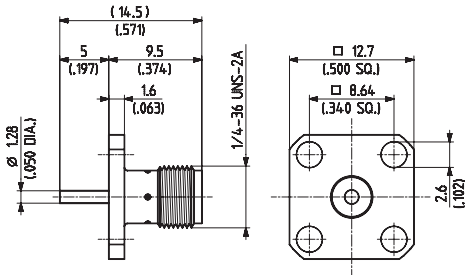
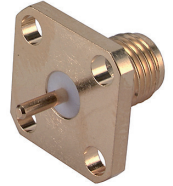

HUBER+SUHNER type	Item no.	Packaging	Plating body	Notes
23_SMA-50-0-21/111_NE	22640101	single	gold	flush dielectric

## Right angle panel receptacle

With solder end, jack (female)

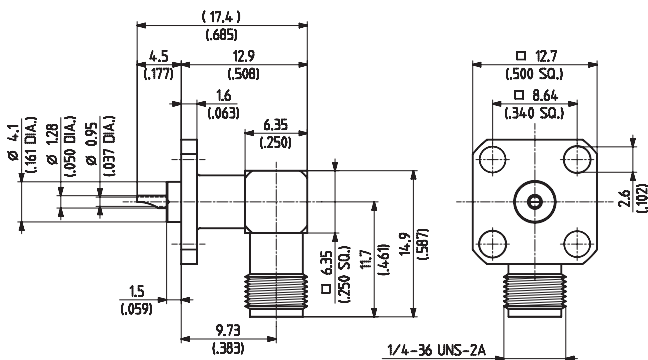
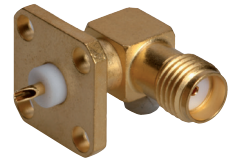

HUBER+SUHNER type	Item no.	Packaging	Plating body	Notes
28_SMA-50-0-1/111_NE	22641321	single	gold	extended dielectric

# Series SMA – receptacles

26.5 GHz – straight panel receptacle

With tab end, jack (female)

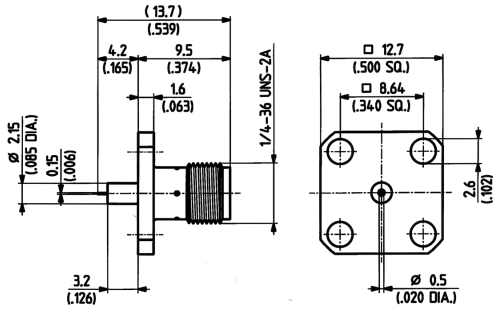

HUBER+SUHNER type	Item no.	Packaging	Plating body	Mounting hole	Notes
23_SMA-50-0-94/199_NE	22649049	single	passivated stainless steel	ML 93	extended dielectric



# Series SMA - PCB connectors

## Straight PCB jacks (female)

- Edge mount



SMA

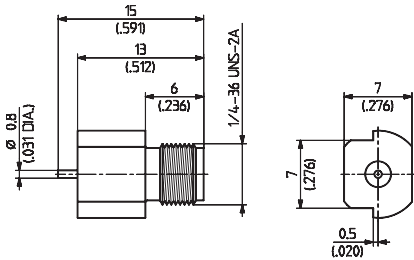

Fig. 1

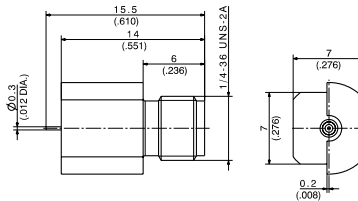

Fig. 2

HUBER+SUHNER type	Item no.	Packaging	Plating body	Mounting hole	Fig.
82_SMA-S50-0-45/111_NE	22652330	single	SUCOPRO® gold plating	ML 132	1
82_SMA-S50-0-45/111_NM	84037646	tape and reel 500 pcs.			
92_SMA-50-0-10/111_NE	84120623	single	SUCOPRO® gold plating	ML 132	2
92_SMA-50-0-10/111_NM	84036781	tape and reel 500 pcs.			

All highlighted types are HUBER+SUHNER ECO types.

## Straight PCB jacks (female)

- Without stand-off

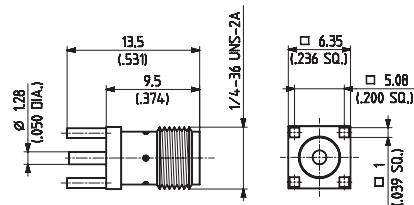

HUBER+SUHNER type	Item no.	Packaging	Plating body	Mounting hole
82_SMA-50-0-1/111_NE	22543359	single	gold	ML 41
82_SMA-50-0-1/111_NH	22644334	bulk 100 pcs.		

# Series SMA - PCB connectors

## Right angle PCB jacks (female)

- Without stand-off

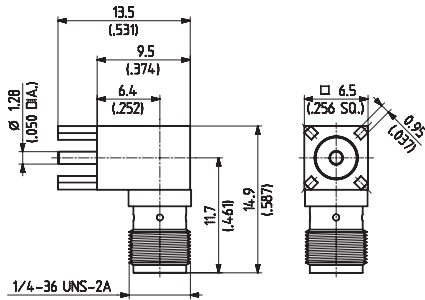

HUBER+SUHNER type	Item no.	Packaging	Plating body	Mounting hole
85_SMA-50-0-101/111_NE	22658792	single	gold	ML41
85_SMA-50-0-101/111_NH	22652140	bulk 100 pcs.		

- With stand-off

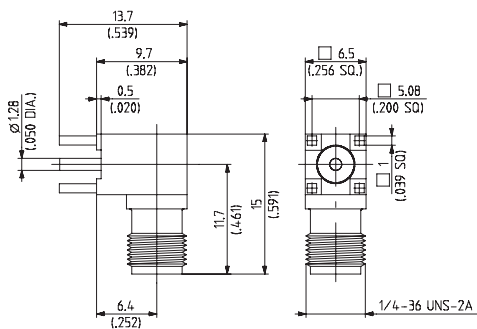

HUBER+SUHNER type	Item no.	Packaging	Plating body	Mounting hole
85_SMA-50-0-144/111_YH	23000527	bulk 100 pcs.	gold	ML41

# Series SMA – protective caps and shorts

## Caps for jacks

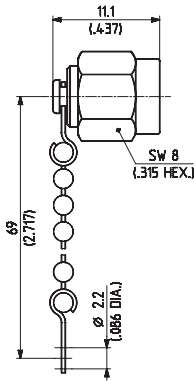

Fig. 1

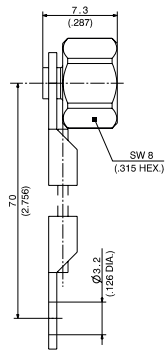

Fig. 2



HUBER+SUHNER type	Item no.	Packaging	Plating body	Notes	Fig.
62_SMA-0-0-1/-11_E	22640159	single	gold	with chain	1
62_SMA-0-0-8/-3_E	84120887	single	SUCOPLATE®	with wire, IP68	2

All highlighted types are HUBER+SUHNER ECO types.

## Shorting cap

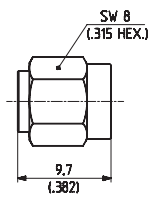

HUBER+SUHNER type	Item no.	Packaging	Plating body
64_SMA-50-0-1/111_NE	22640161	single	gold